

chiron

CNC-Präzisionsmaschinen

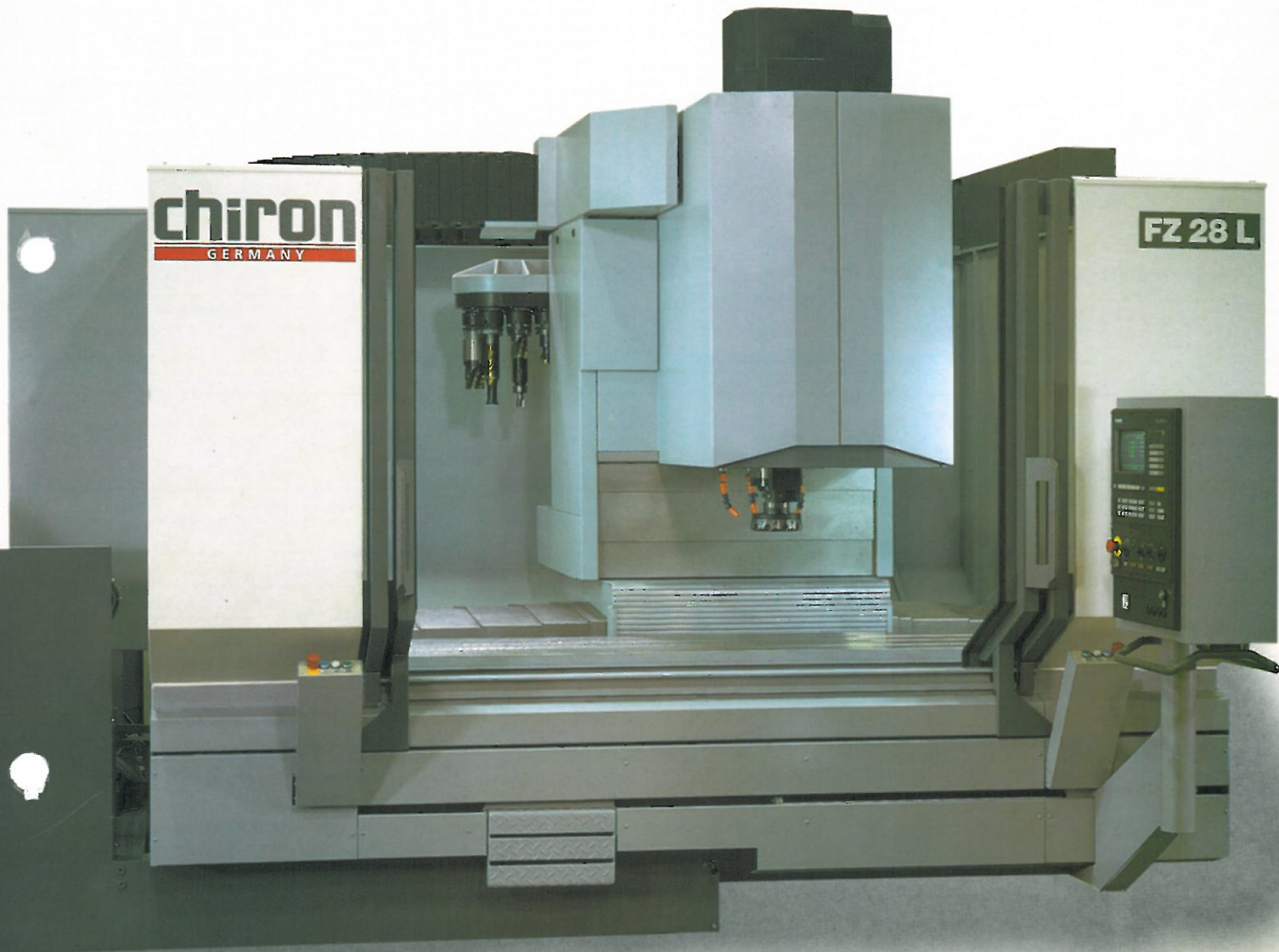

FZ 28 L

Tools

Tool changing time	1.9 s
Chip-to-chip time	3.9 s
Speed range up to	10.500 rpm
Rapid X-axis up to	40 m/min

SK 50

chiron

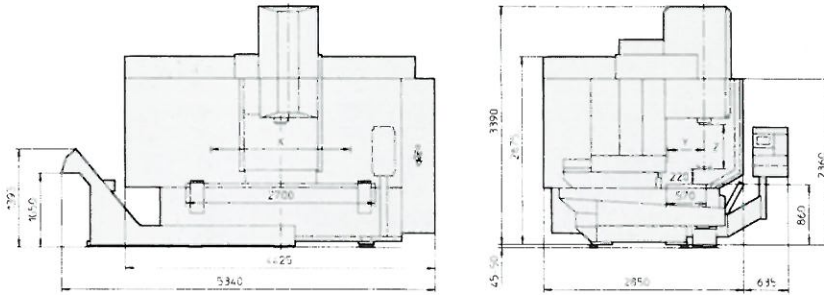

CNC production centre FZ 28 L

Technical Data

Drilling capacity in BSO 60 A 62 (EN 43 D)	45 mm
Tapping	M 36
Milling capacity in BSO 60 A 62 (EN 43 D)	500 cm ³ /min
Tool storage capacity	40
Tool taper DIN 69871	SK 50
Tool diameter	100 mm
if adjacent positions unoccupied	180 mm
Maximum tool weight	25 kg
Maximum tool length	350 mm
Tool change time	approx. 1.9 s
Chip-to-chip time	approx. 3.9 s
Spindle drive	26 kW
Speed range	20 – 7.100 rpm
Maximum torque	300 Nm
Spindle bearing diameter	90 mm
Tool clamping	12 000 N
Throat, Spindle Guideways Cover	550 mm
Distance spindle nose to table surface	220 – 850 mm
Travel X-axis	2000 mm
Travel Y-axis	520 mm
Thrust on X – Y-axis	10 000 N
Travel Z-axis	630 mm
Thrust on Z-axis	14 000 N
Rapid X-axis	40 m/min
Rapid Y – Z-axis	30 m/min
Fixed table, clamping surface	2700 x 570 mm ²
Tennon slots	2 x 18H12
Reference slot	18H8
Chip conveyor, discharge height	1050 mm
Coolant device, container capacity	470 l
Full enclosure	illuminated
Total connected power	48 kVA
Machine weight	approx. 10 t
Floor space	approx. 13 m ²
Air connection	6 bar

Options

Increased speed range	20 – 10500 rpm
Max. torque	300 Nm
Spindle drive AC	26 kW
Heavy duty spindle drive	38 kW
Speed range	20 – 6000 rpm
Max. torque	600 Nm
Drilling capacity in BSO 60 A 62 (EN 43 D)	88 mm
Tapping	M56
Milling capacity in BSO 60 A 62 (EN 43 D)	1200 cm ³ /min
Travel X-axis	up to 6700 mm
Travel Y-axis	630 mm
Travel Z-axis	800 mm
Fixed table	up to 7400 x 680 mm ²
Direct path measuring system	
Multi spindle head max. diameter	180 mm
Through tool coolant	up to 10500 rpm, 20 bar
Automatic doors · NC rotary table · Workpiece transport and hopper equipment · Full enclosure with extraction · Gauges, tool measurement and management · Drill fracture control · Service life monitoring · Lasercontrol	

Subject to technical changes.
Printed in Germany.

Leaflet No. 1880/09/93-E

CHIRON-WERKE GmbH & Co. KG
Postfach 4060 · D-78505 Tuttlingen
Talstraße 23 · D-78532 Tuttlingen
Germany
Telephone (0 74 61) 70 17-0 · Telex 7 62 615
Telefax (0 74 61) 31 59 or 70 17-1 51